

Instructions for the use of Softpen

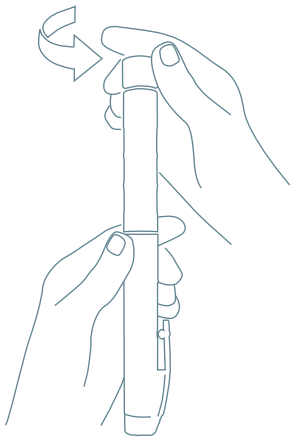

1 / Unscrew pen cap

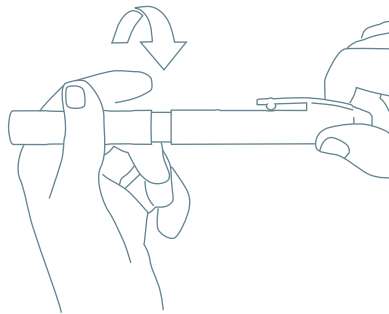

2 / Unscrew metal body

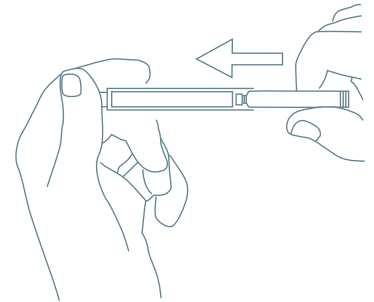

3 / Remove plastic cartridge holder and insert cartridge

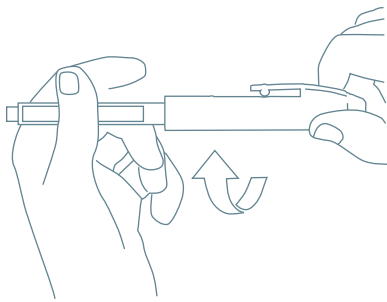

4 / Attach plastic cartridge holder

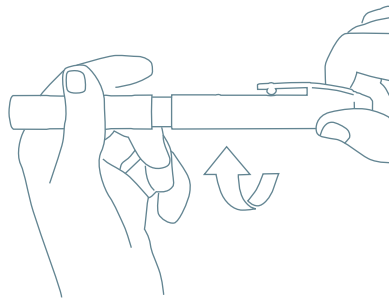

5 / Attach metal body

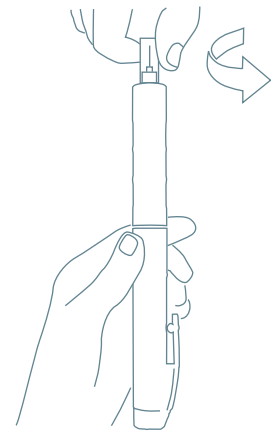

6 / Remove paper tab, attach needle and remove outer needle cover

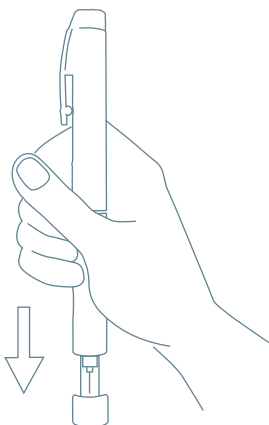

7 / Activate pen with cap

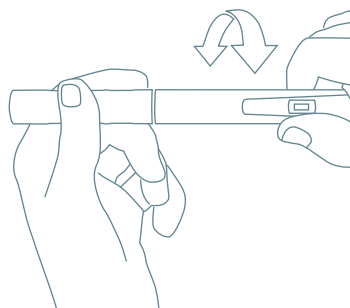

8 / Dial dose

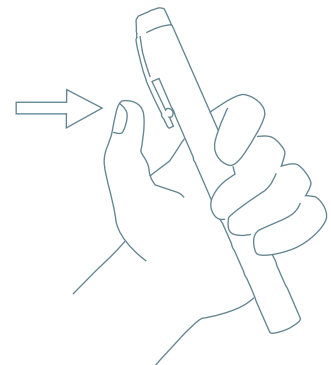

9 / Place the Softpen on injection site and depress clip to inject